

Powerful PFC Chokes

Product series: BWLX-PQ2620A series

Patent protected!

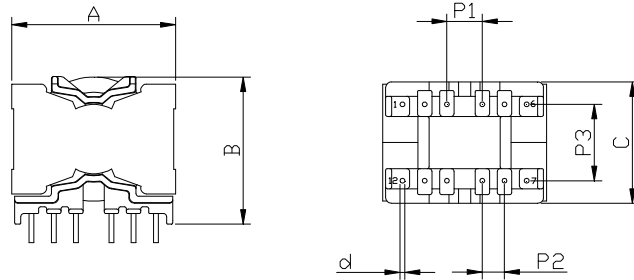

Features:

- Excellent performance on efficiency
- Cost effective design
- IEC standard core type
- Very good heat dissipation
- High reliability and temperature stability

Applications:

- 90 Plus - Power supply units
- Buck-boost converters
- Energy storage requirement

NEW

• Dimensional specifications:

unit in mm

A	B	C	ϕd	P1	P2	P3
27.8max	26max	21.3max	0.8 \pm 0.1	5.9	3.7	13.2

• Electrical specifications:

Product name	Inductance $\pm 10\%$ (μ H)	Max. Rdc (m Ω)	PF value	Suitable power*
BWLX-PQ2620A-531	530	225	> 95%	200W
BWLX-PQ2620A-401	400	175	> 95%	250W
BWLX-PQ2620A-301	300	140	> 95%	300W

*Only reference for PFC choke applications for PSU with Vin=90Vac

• DC-bias property: (typical curves)

