

# SWITCHING POWER TRANSFORMER

## FOR PC POWER SUPPLY

### FEATURES:

- \* CONSTRUCTED WITH UL APPROVED CLASS B INSULATION SYSTEM(UL FILE NO:E359513).
- \* COMPLIANT WITH RoHS AND HALOGEN FREE.

### APPLICATION

- \* PC POWER SUPPLY.      \* AC/DC ADAPTER.

### ELECTRICAL SPECIFICATION:

| MODEL NO | FREQUENCY (KHz). | OUTPUT POWER (W) | EXTERNAL SIZE W*L*H(mm) | BOBBIN TYPE | CORE CROSS-SECTIONAL AREA(mm <sup>2</sup> ) |
|----------|------------------|------------------|-------------------------|-------------|---|
| PQ26X20  | 60~150           | 60               | 27*29*24                | VERTICAL    | 119.0                                       |
| ERL28    | 60~150           | 250              | 30*27*37                | VERTICAL    | 85.6  |
| ERL35    | 60~150           | 400              | 37*33*46                | VERTICAL    | 107.0                                       |
| ETD29    | 60~100           | 100              | 36*36*28                | HORIZONTAL  | 76.0  |
| ETD34    | 60~150           | 250              | 40*40*31                | HORIZONTAL  | 97.1  |
| ERL39    | 60~150           | 500              | 39*35*48                | VERTICAL    | 128.3                                       |

### PHYSICAL DIMENSION : (UNIT:mm)

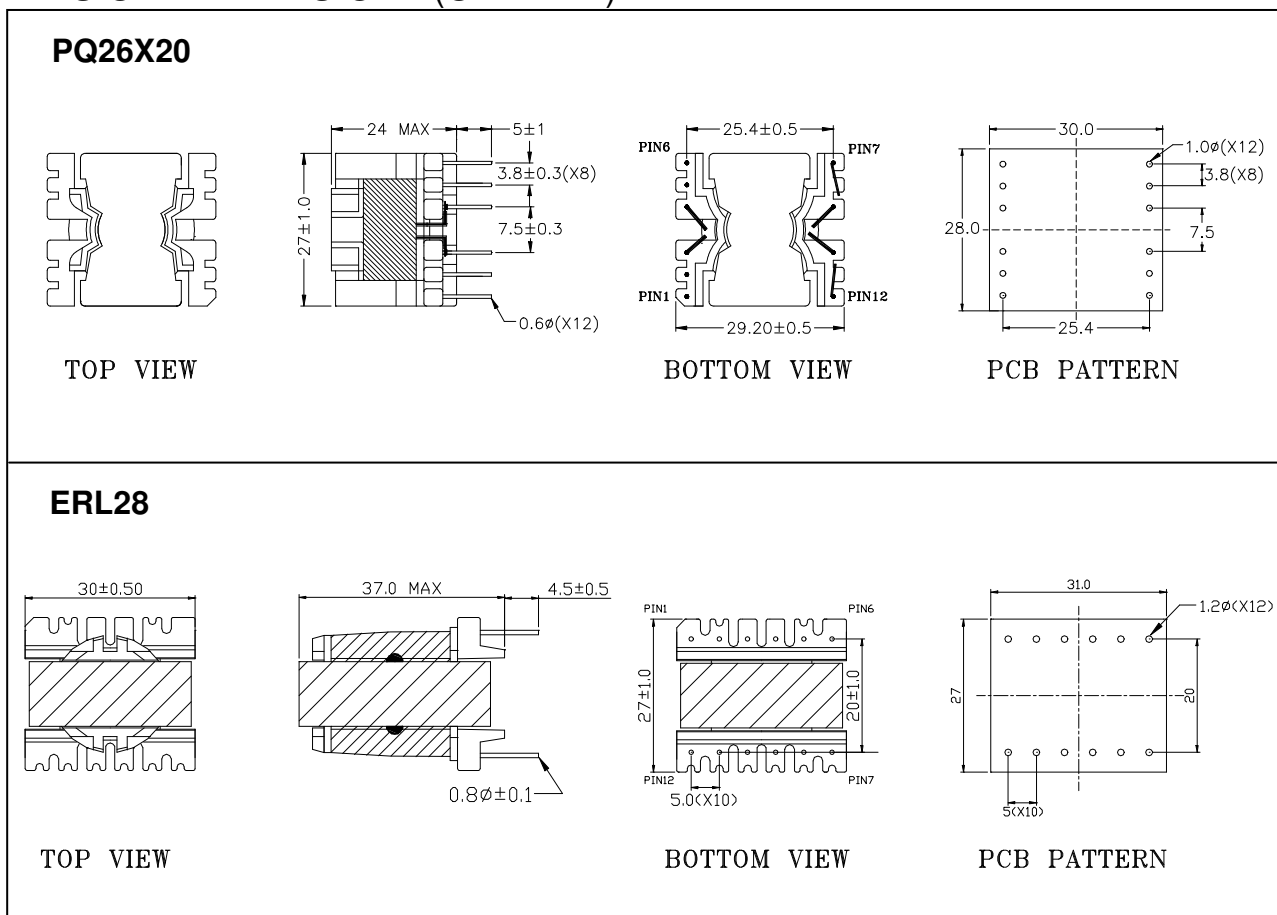

PHYSICAL DIMENSION : (UNIT:mm)

**ERL35**

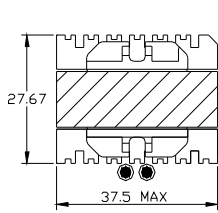

TOP VIEW

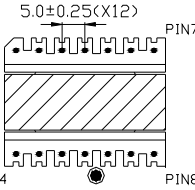
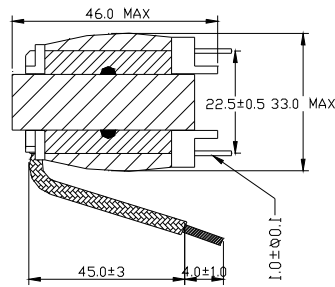

BOTTOM VIEW

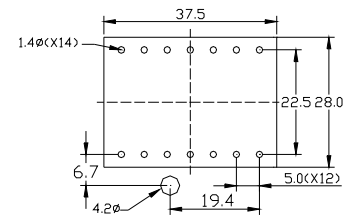

PCB PATTERN

**ETD29**

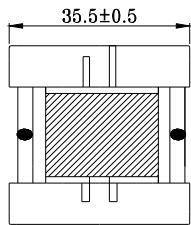

TOP VIEW

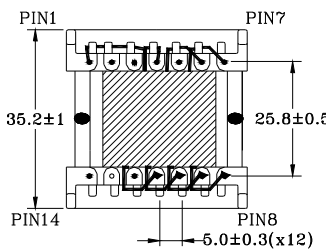
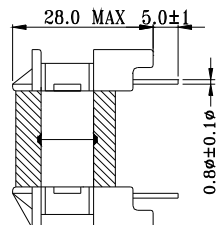

BOTTOM VIEW

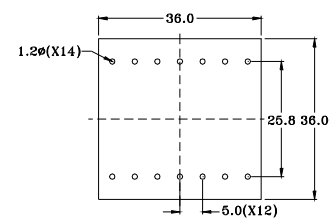

PCB PATTERN

**ETD34**

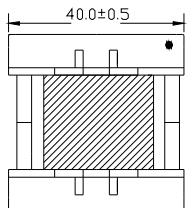

TOP VIEW

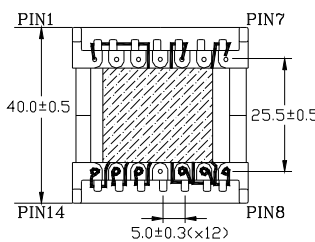
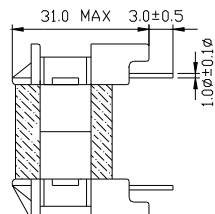

BOTTOM VIEW

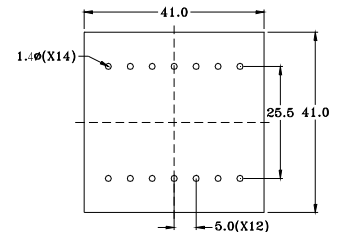

PCB PATTERN

**ERL39**

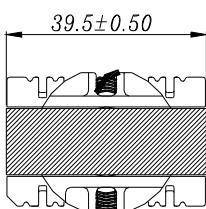

TOP VIEW

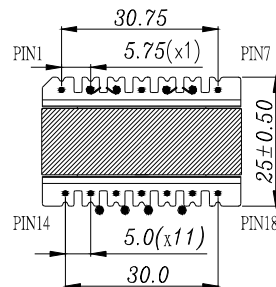
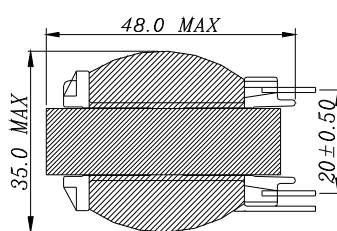

BOTTOM VIEW

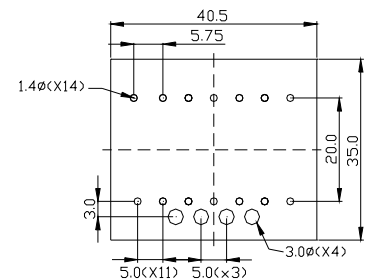

PCB PATTERN