

COMMON MODE CHOKE

MODEL NO : PCC-15012 SERIES

FEATURES:

- * LOW PROFILE .
- * EXCELLENT ATTENUATION CHARACTERISTICS IN LOW FREQUENCY BAND.
- * COMPLIANT WITH RoHS AND HALOGEN FREE.

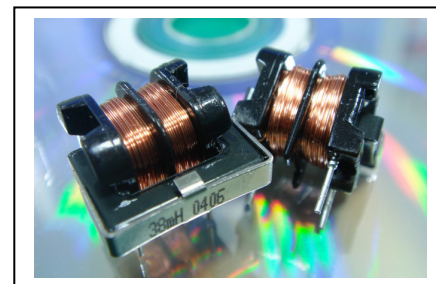

APPLICATION:

- * AV EQUIPMENT, DIGITAL CONSUMER ELECTRONICS.
- * LED DRIVER.
- * AC/DC ADAPTER.

ELECTRICAL SPECIFICATION:

MODEL NO	INDUCTANCE $\pm 30\%$ (mH)	RATED CURRENT (A rms)	DCR MAX (OHM)
PCC-15012-802 HF	8.0	0.30	0.83
PCC-15012-123 HF	12.0	0.20	1.50
PCC-15012-303 HF	30.0	0.10	2.80

SCHEMATIC:

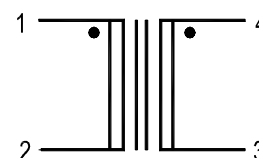

NOTE(1): Operating temperature(including self- temperature rise):-20°C ~ +120°C.

NOTE(2): Storage temperature:-20°C ~ +85°C.

NOTE(3): Test frequency : @ 10 KHZ, 1Vrms.

NOTE(4): Rated voltage : 85 ~265 VAC.

NOTE(5): Dielectric with standing voltage : 1500 VAC for 1 minute between winding and winding.

PHYSICAL DIMENSION : (UNIT:mm)

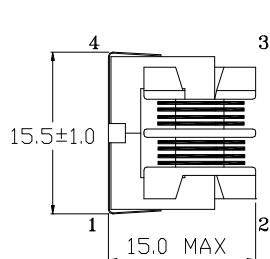

TOP VIEW

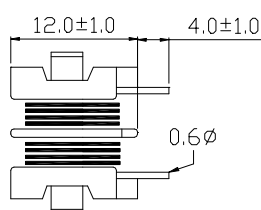

BOTTOM VIEW

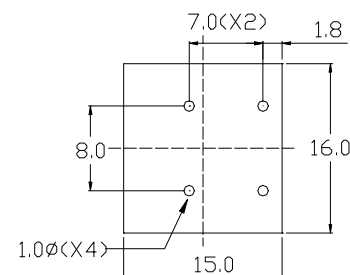
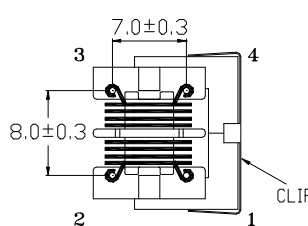

PCB PATTERN