

SPECIAL POWER CHOKES

NEW

Patent protected!

FEATURES:

1. Almost no stray capacitance caused by winding
2. Very high reliability due to automatic winding process
3. Lower temperature rise due to good thermal dissipation
4. Good EMI performance without additional copper foil screening

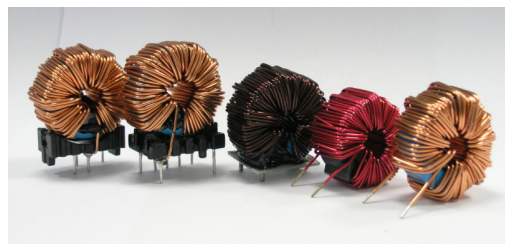

APPLICATIONS:

PFC chokes, Output chokes and DM chokes for power supply units

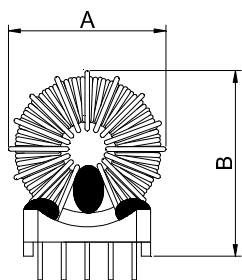

Figure 1

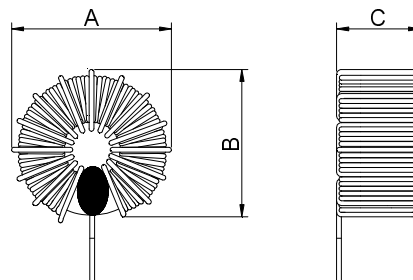

Figure 2

BW Part Number	Inductance (μ H)	Rated current (A)	DC resistance (m Ω) max	Finished dimensions (mm)				Wire size (mm)
				A (max)	B (max)	C(max)	Fig.	
GSL2A-080XXVN	250	2	200	25	24	10	2	0.7
GSL2A-092XXVN	540	5	170	30.5	29	20.5	2	0.8
GSL2A-106XXVN	400	6	100	36.5	34	23.5	2	1
GSL2A-106XXVB	650	5	150	36.5	40	23.5	1	0.9
GSL2A-130XXVN	380	8	50	40	42	24	2	1.4

※ Other specifications not shown in the above list are under request.

- The special automatic winding on the ring core shows no obvious resonance behavior:

Self resonance measurement

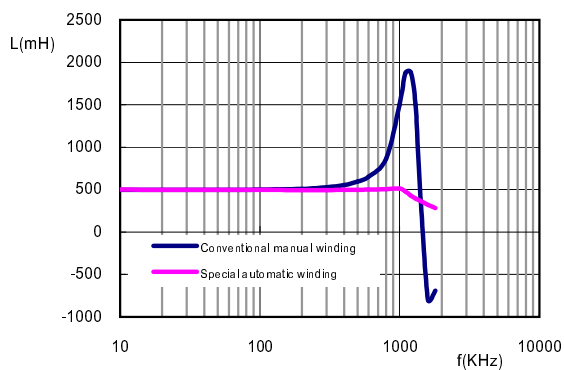

- The special automatic winding on the ring core shows better EMI suppression performance:

Insertion loss measurement

